

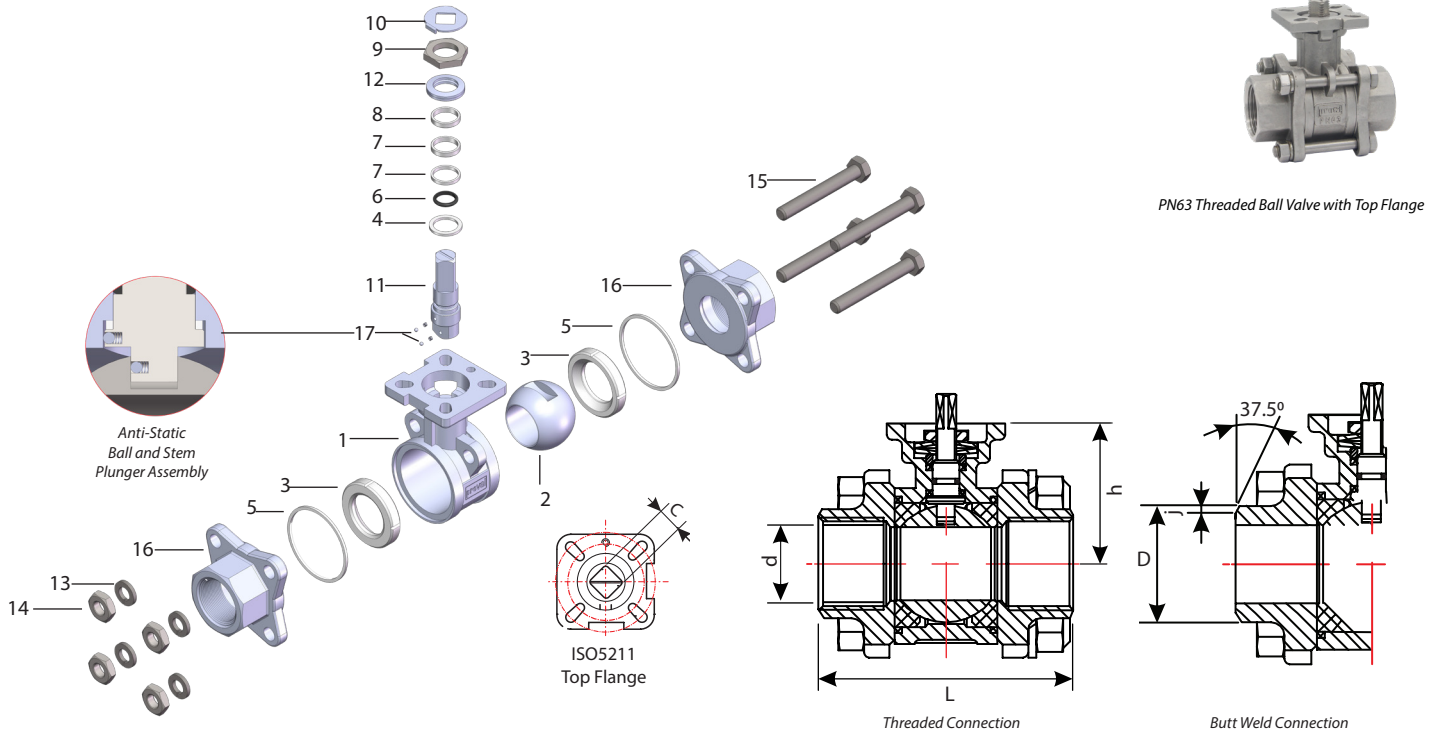

V203 Series 3-Piece, ISO5211 Direct Mount Ball Valves

V203 Series ball valves are designed in PN63 pressure class and available in sizes from 1/4" to 4". They are equipped with a top flange compliant with ISO 5211 for direct actuator mounting, feature an anti-static design, and are certified in accordance with ATEX directives.



Material List

No	Part Name	Material	Qty	No	Part Name	Material	Qty	No	Part Name	Material	Qty
1	Body	AISI316	1	7	V-Ring	PTFE	1	13	Spring Washer	AISI304	4 (Max 12)
2	Ball	AISI316	1	8	Thrust Washer	AISI304	1	14	Stud Nut	AISI304	4 (Max 12)
3	Ball Seat	Glass Fiber Reinforced PTFE* Graphite Reinforced PTFE	2	9	Gland Nut	AISI304	1	15	Stud Bolt	AISI304	4 (Max 6)
4	Washer	PTFE	1	10	Locking Washer	AISI304	1	16	Cap	AISI316	2
5	Body Seal	PTFE	2	11	Stem	AISI316	1	17	Anti-Static Device	AISI316	2
6	Stem O-Ring	Viton	1	12	Belleville Washer	AISI301	2				

*Standard construction material for ball seats.

Dimensions(mm)

Size (DN)	d	L		h	c	D	J	ISO5211 Top Flange	Torque (N.m)	Kv (m³/h)	Net Unit Weight (kg)
		ISO7/1 & SW (DIN3202-M3)	BW (DIN3202-S13)								
1/4"	11	50	70	43	9	18.1	1.10	F03	4	8,6	0,46
3/8"	12,5	60	70	43	9	18.1	1.10	F03	4	16	0,48
1/2"	15	75	75	48	9	21.7	1.75	F03	5	35	0,51
3/4"	20	80	90	53	11	27.2	2.00	F04/F05	8	46	0,89
1"	25	90	100	58,5	11	34	2.50	F04/F05	10	72	1,27
1-1/4"	32	110	110	71	14	42.7	2.75	F05/F07	14	105	2,04
1-1/2"	40	120	125	76,5	14	48.6	3.00	F05/F07	18	170	3,00
2"	50	140	150	85	14	60.5	3.25	F05/F07	25	275	3,80
2-1/2"	65	185	190	100	17	76	3.50	F07/F10	48	507	7,80
3"	80	205	220	112,5	17	93	4.00	F07/F10	75	905	12,40
4"	100	240	270	125,5	17	116	5.50	F07/F10	110	1414	20,80

